

CALIBRATION TANK & CALIBRATION TANK INSERT

The RAS Calibration and Verification Tank allows for periodic verification of correct tool operation and allows the tool to be tested at surface in a safe fashion. The tank is fabricated from steel and filled with water. The water provides excellent shielding and a known point for the tool verification.

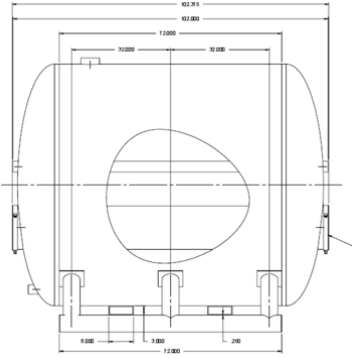

SKU: RASCT01

Category: [Formation Evaluation](#)

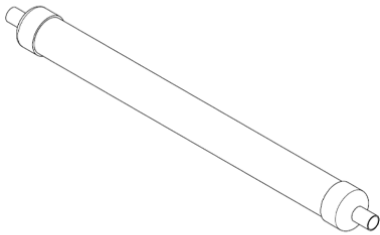

PRODUCT DESCRIPTION

The RAS Calibration and Verification Tank allows for periodic verification of correct tool operation and allows the tool to be tested at surface in a safe fashion. The tank is fabricated from steel and filled with water. The water provides excellent shielding and a known point for the tool verification.

The Calibration Tank Insert provides a “hydrocarbon” point during testing and verification.

Applications / Features

- Test and verification of the RAS tool